

## Swab – gynecological cytology, PCR detection of pathogens: ThinPrep®

ThinPrep® Pap Test™, various kits for sampling

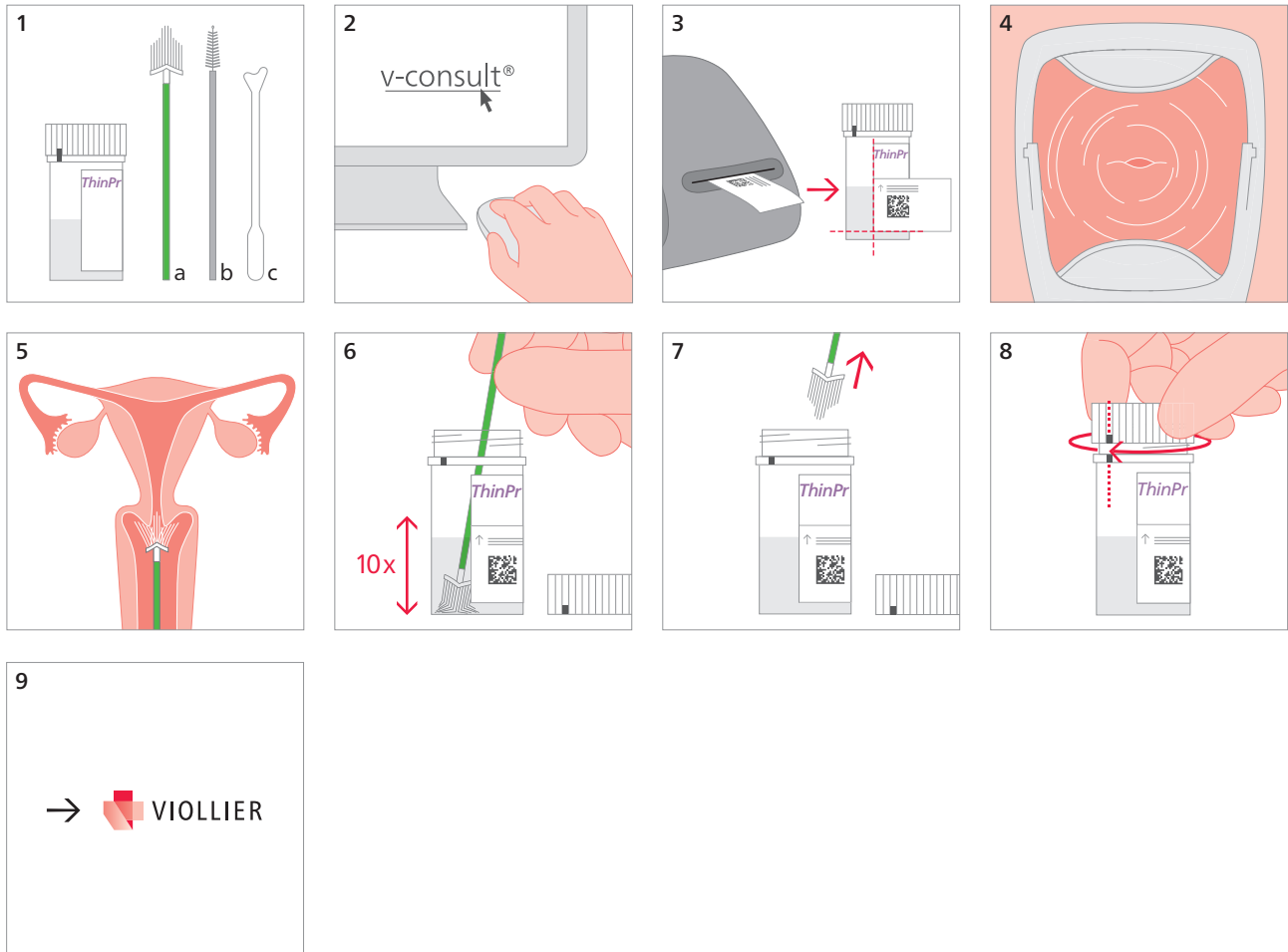

- 3 Place the barcode label on top of the existing label in alignment with the left and bottom border
- 4 Position cervix uteri. Gently remove covering secretions
- 5 Material sample:
  - a Using **Cervex-Brush®** oder **Cervibrush® Plus**  
Apply gentle pressure in direction of cervix, until lateral bristles are pushed to the ectocervix  
Maintain gentle pressure while turning clockwise 5 times
  - b / c Using **Cytobrush® Plus GT / Plastic spatula**  
Introduce into cervical canal, until only the last bristles are visible  
Slowly perform ¼ or ½ turn. Do not overturn
- 6 Rinse brush in the PreservCyt solution. Press the brush head **firmly 10 x** against the bottom of the tube, so that the bristles are pushed apart
- 7 Discard brush. **Do not leave brush head inside the tube**
- 8 Firmly close the tube, until the two marks on the tube and the cap are aligned

Lubricants may affect sample preparation and may impair microscopic interpretation of cell-smears. Please avoid using them.

The recommended lubricant Gyn-Lys (art. no. 600560) is available at v-shop®.

Shipping material:

Please label with name, first names and date of birth of the patient