

## Blood sampling – coagulation

Citrate tube, light blue (4)

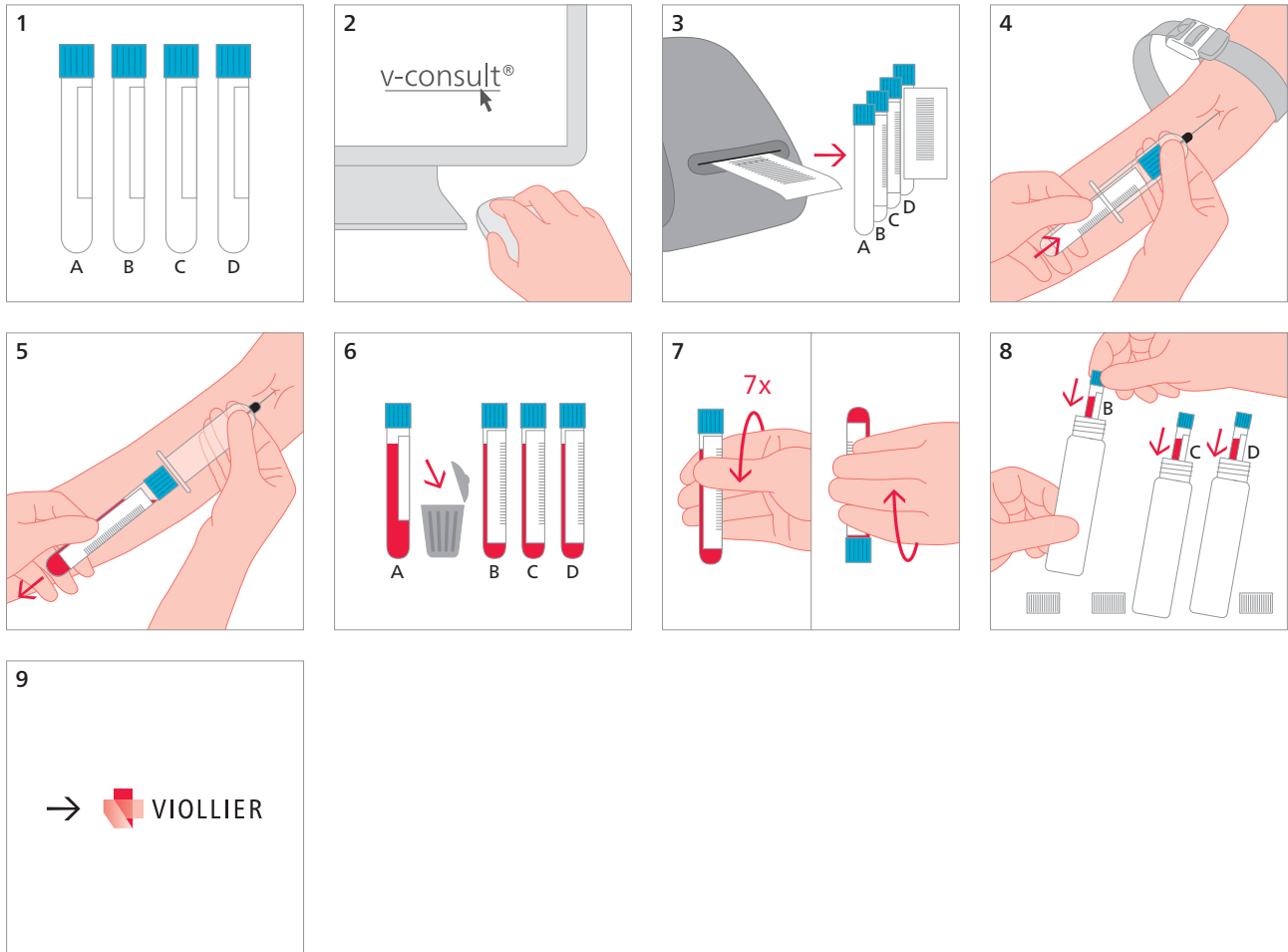

- |       |   |
|-------|---|
| 1     | Check expiry date   |
| 4     | Constrict the blood flow with the tourniquet as little as possible or release the tourniquet immediately after penetrating the vein<br>Do not tap vein<br>Atraumatic venipuncture |
| 6     | Discard first tube (A)<br>Completely fill tube up to the mark (mixture ratio blood:citrate)   |
| 8 – 9 | Transport uncentrifuged tubes immediately by courier<br>Special coagulation investigations: inquire by phone and define time of transport   |

Shipping material:

Please label with name, first names and date of birth of the patient