

## Blood sampling – cold agglutinins

Tube without additive, red (2)

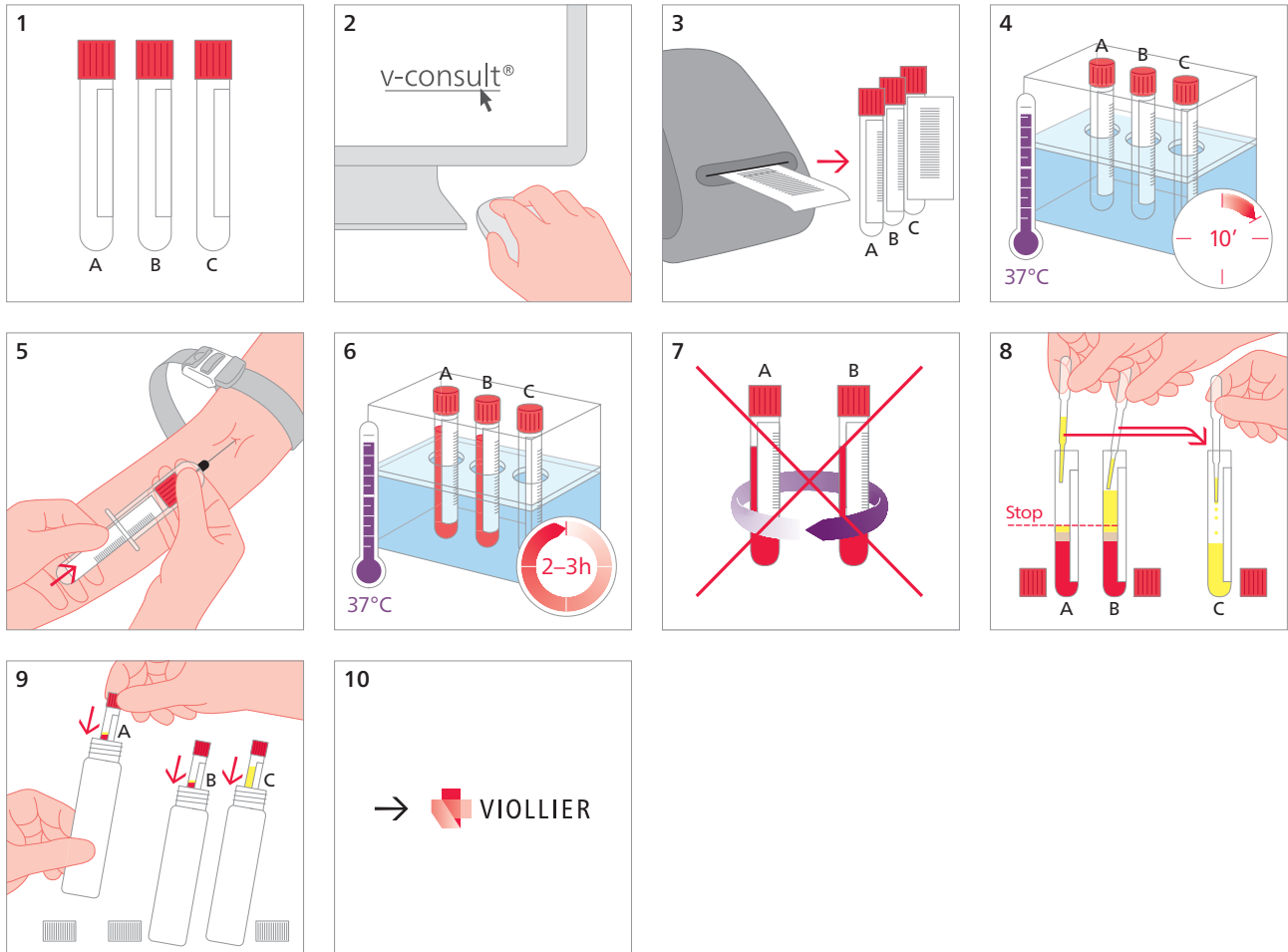

- Preheat the tubes for 10 minutes at 37°C
- Sample in 2 tubes without additive, red
- Sedimentation for 2 – 3h at 37°C, **do not centrifuge**
- Transfer serum in tube 3 without additive, red
  - Approximately 4 mm safety distance from the sediment
  - Pipette carefully: erythrocytes may alter the result of the analysis
- If this kind of preanalytical procedure may not be guaranteed at the physicians practice, sampling at Viollier may be arranged by phone
- Sampling time: monday – thursday

Shipping material:

Please label with name, first names and date of birth of the patient